

## Optima Ajax <Ready> manual

### (Pre-download the Ajax application from GooglePlay)

**1. Create an account.** Click «Register» in the downloaded application. In the open window, enter the data, after that, the account confirmation will be sent to the phone and e-mail. Enter passwords in the appropriate fields in the application. If all the data are correct, HUB2 will be registered.

**2. Add HUB2 to the system:** scan through the application the QR code that is inside the box with the device or directly on the HUB2 (or enter the name manually - it is located under the QR code), give the name of the device as desired.

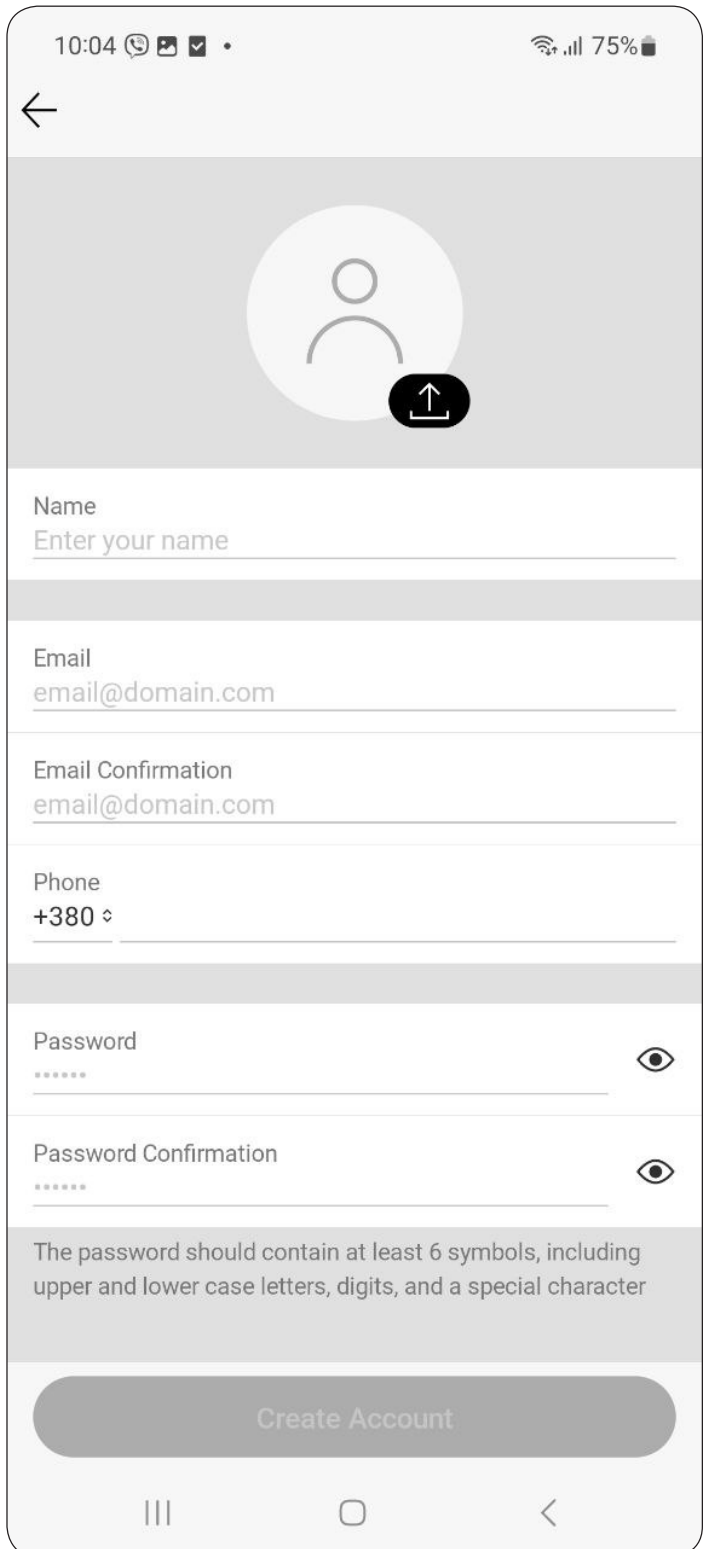

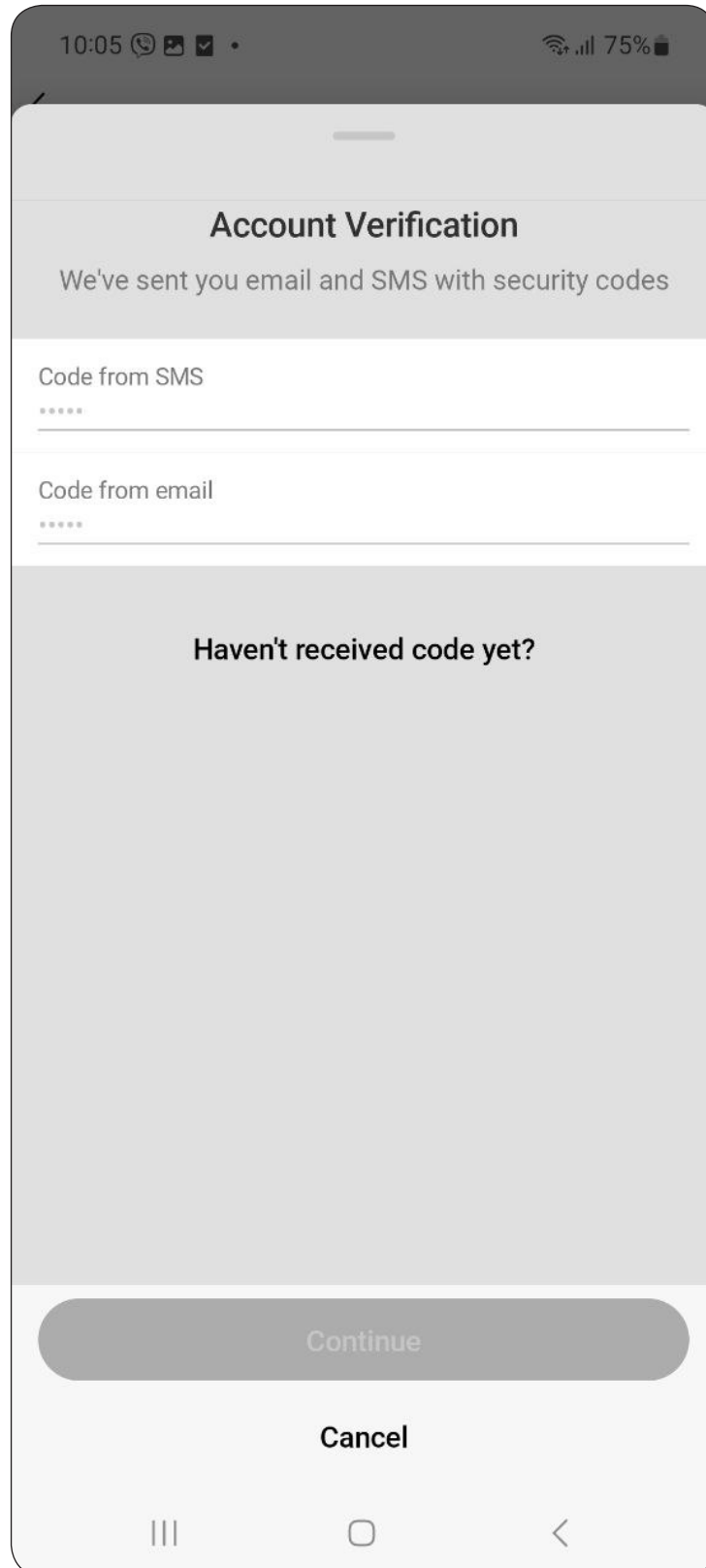

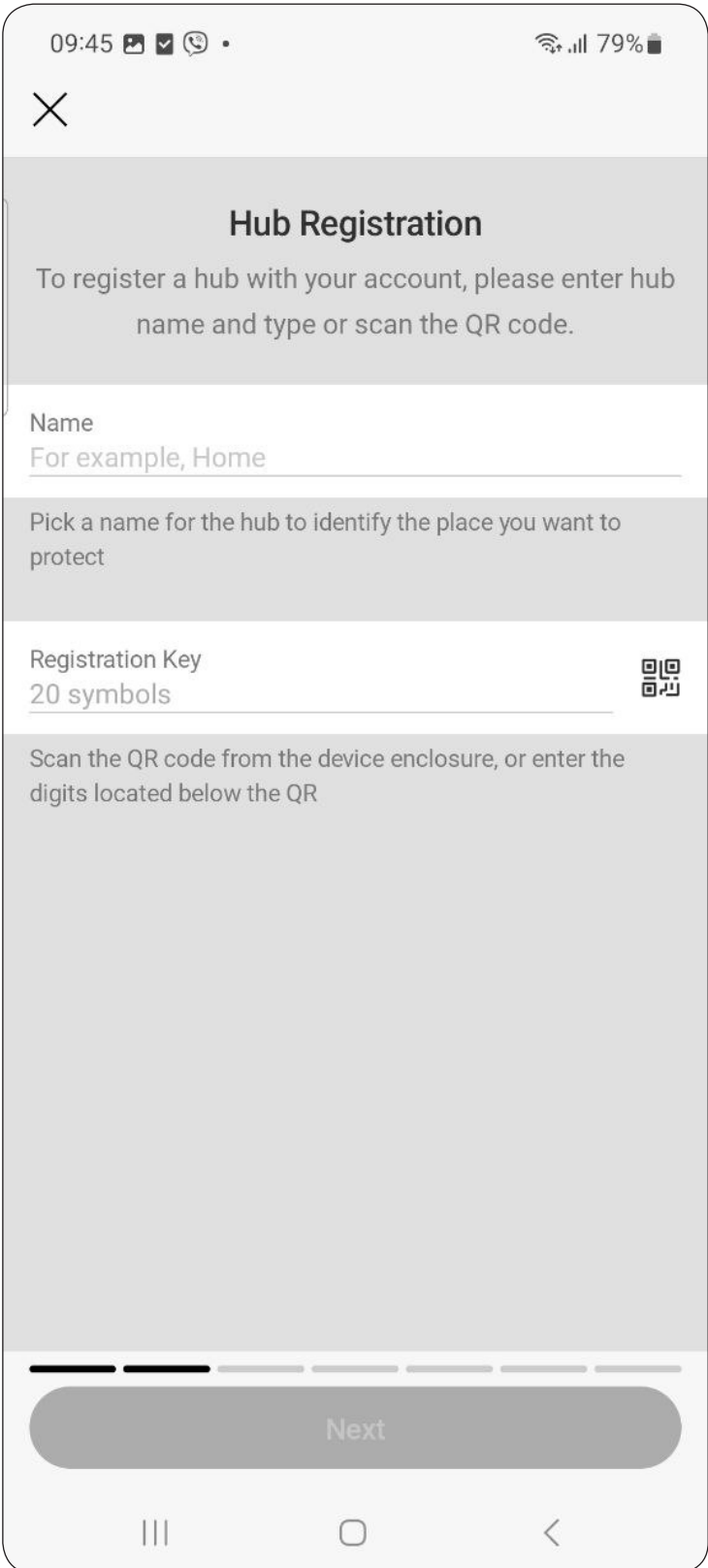
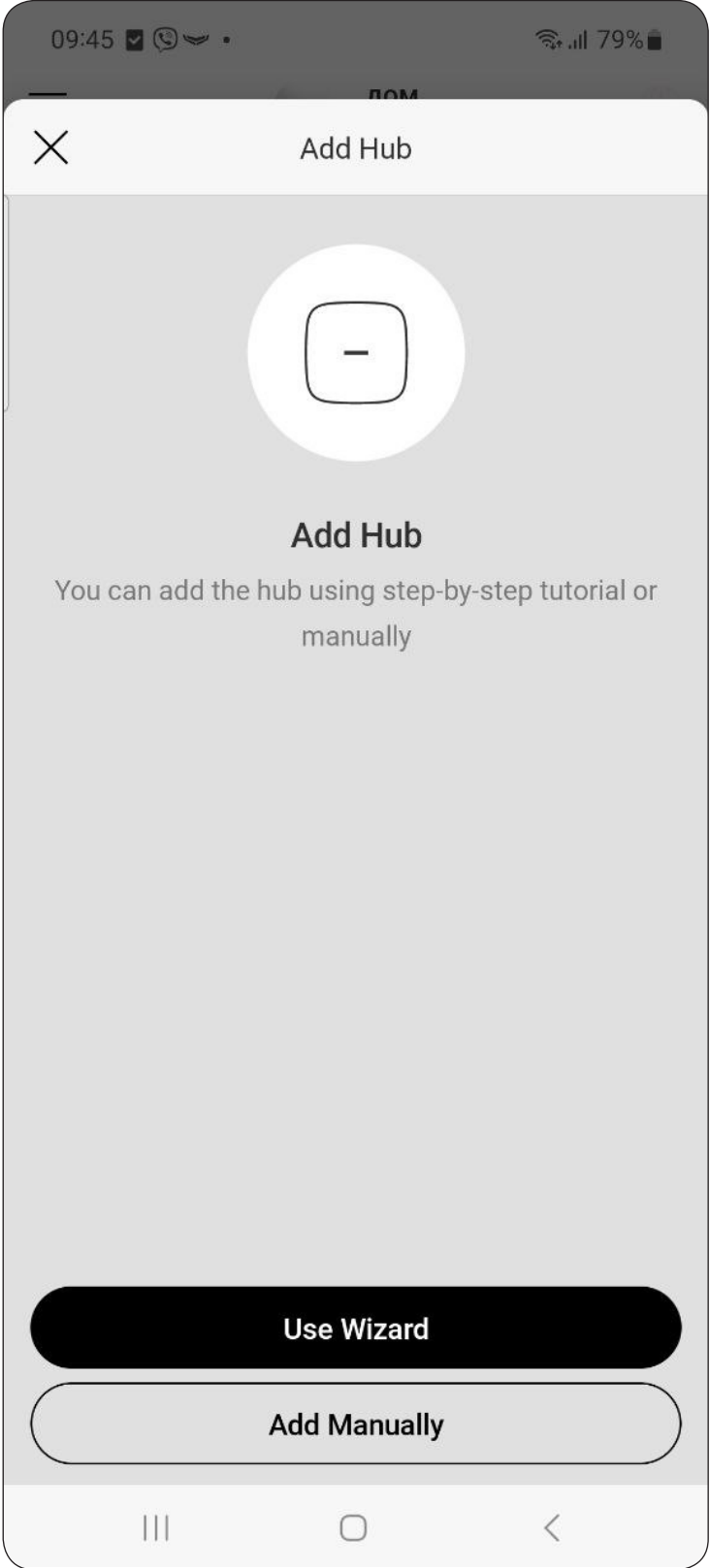

### 3. Connection to HUB2 of the LifeQuality Jeweler sensor

LightSwitch (CO<sub>2</sub>) and Optima recuperator relay: click «Devices» and add the necessary equipment. Enable «Dry Contact» (Optima recuperator name by default - the name can be changed in the hardware settings) by moving the slider to the ON position.

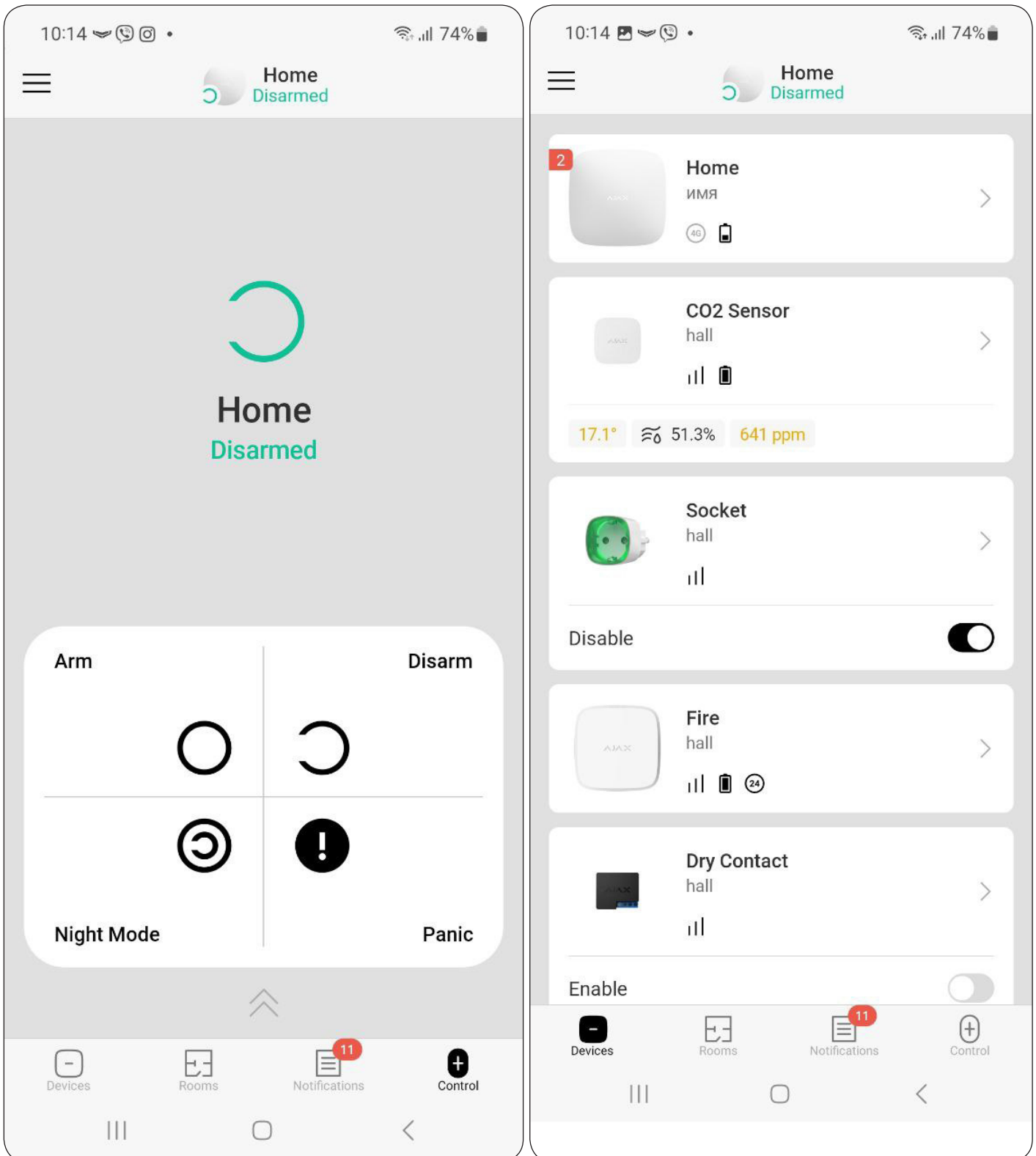

#### 4. Starting the recuperator in automatic mode and setting up the LifeQuality Jeweler sensor (CO<sub>2</sub>)

To start the heat recuperator in automatic mode according to the prescribed operating scenarios, select «A:on» on the remote control using the “Skreen” button. To switch to manual control of the heat exchanger, select «A:off».

Development of an individual scenario of recuperator operation depending on CO<sub>2</sub> level indicators:

In the sensor menu, select «Settings» then «Scenarios» and manually set the CO<sub>2</sub> level to «HIGH» and «LOW» (optimal CO<sub>2</sub> level indicators for a person are indicated in the basic instructions for the Optima recuperator). These indicators will set the recuperator operation algorithm in automatic mode, namely:

4.1 When the CO<sub>2</sub> level crosses the «HIGH» mark, the recuperator will move to 1 level higher, in this mode it will continue to purify the air for 30 minutes.

If the CO<sub>2</sub> level does not reach the «LOW» mark during this time, the recuperator will move to 1 level higher. In this scenario, the recuperator will increase its power until it reaches the 4th mark. At maximum capacity, the recuperator will work for 2 hours.



4.2 If the level of CO<sub>2</sub> does not decrease during this time, the recuperator will turn on the notification mode - at the same time, the indicator of switching speeds (|||) will start flashing.

This means that the recuperator cannot lower the CO<sub>2</sub> level and it is necessary to open the crown as an additional source of air.

4.3 If this problem occurs several times in a row, it means that the capacity of the recuperator does not correspond to the actual conditions of its use, we advise you to contact the ClimTesc company in order to solve this problem.

4.4 If the CO<sub>2</sub> level reaches the «LOW» mark during 30 minutes of operation of the recuperator, it will automatically drop to the previously set mode (50% power).

4.5 In the event of an emergency power outage, the recuperator will turn off the flow shut-off valve, thereby blocking air access, the delay when turning on the power is 10-15 seconds.

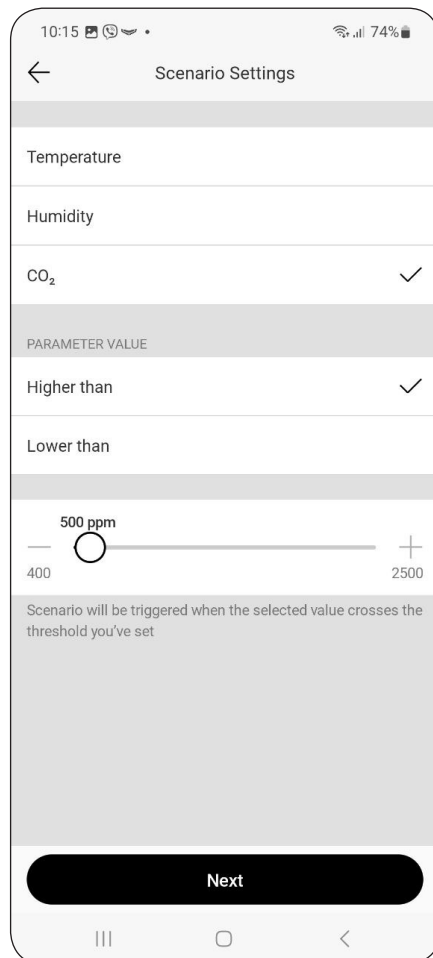
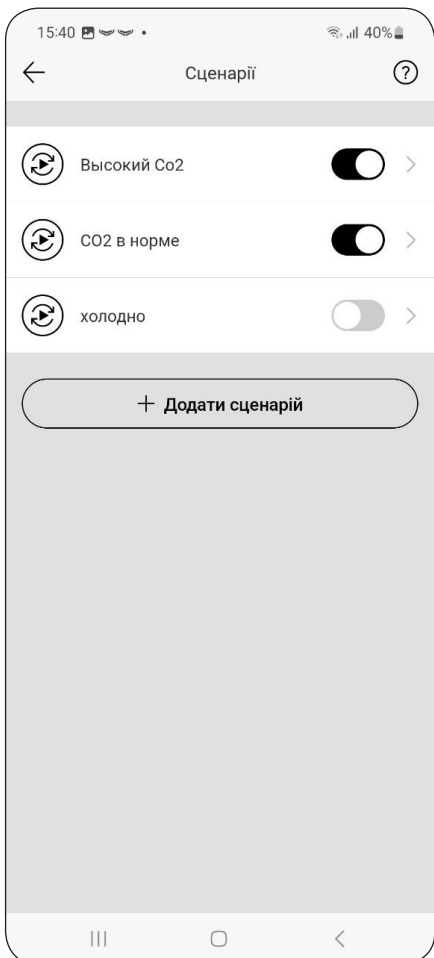
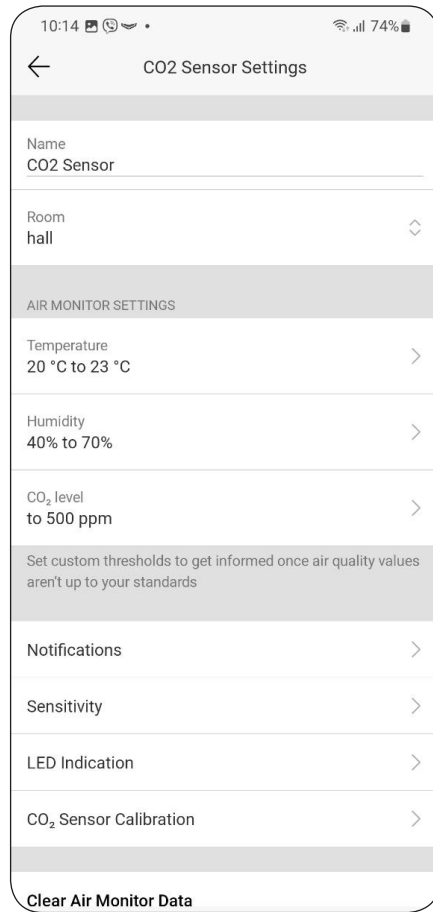
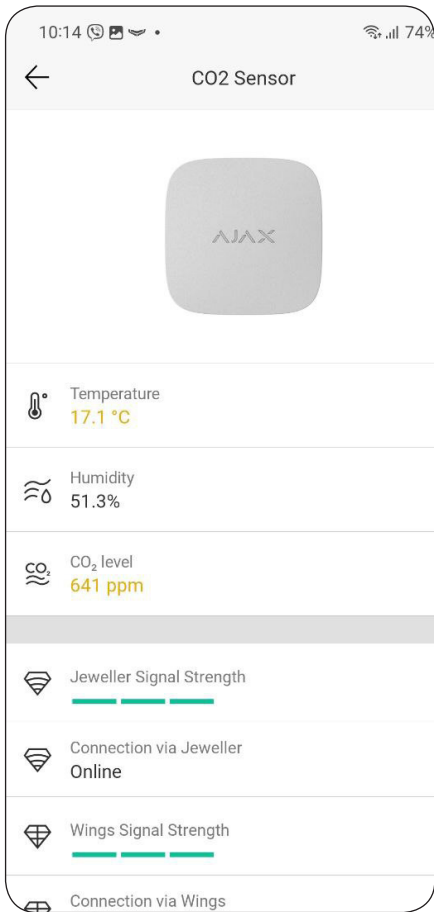

10:16 74%

### Scenario Settings

Name  
high

DEVICE ACTION

Switch on

Switch off

Switch state

Set which action the device to perform: switch on/off, or switch contacts state to the opposite

Save

10:16 74%

### Scenario Settings

Name  
low

DEVICE ACTION

Switch on

Switch off

Switch state

Set which action the device to perform: switch on/off, or switch contacts state to the opposite

Save

### FireProtect Jeweler sensor

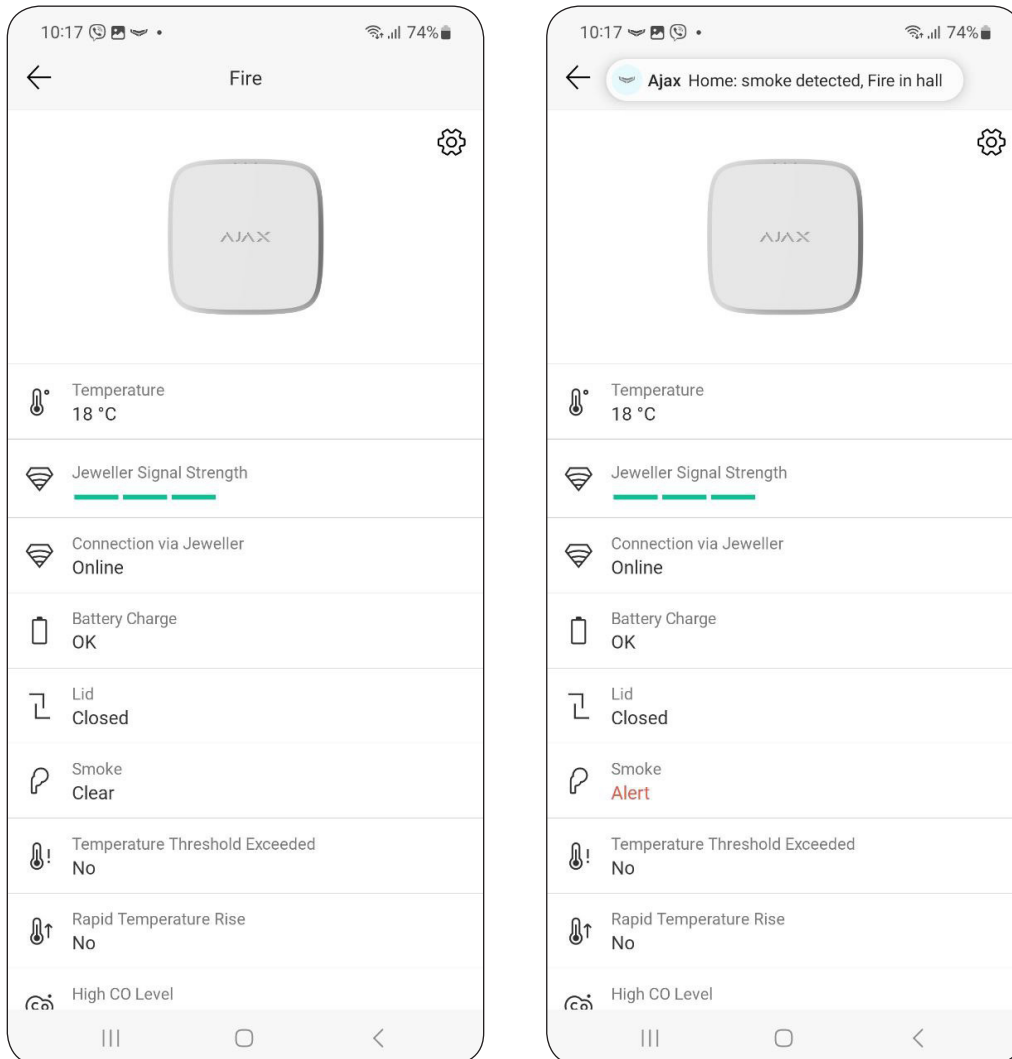

In the automatic mode of operation of the recuperator, when the fire alarm system is activated, the Socket Jeweler will be turned off and, in accordance with the logic of the system, the flow shut-off valve in the recuperator will be closed. Thus, air from the outside will not enter the room, which will help reduce the consequences of a fire.

When the FireProtect Jeweler detects that there is no smoke, it will turn on the Socket Jeweler within 10 minutes

According to this logic, other sensors can be connected to the system, for example, a flood sensor, etc.